

QUICK GUIDE

Luna IPx4 ceiling lift

IMPORTANT

- Make sure that the user's head is at a safe distance from the ceiling lift and strap during transfer.
- The hand control must always be connected in order for the lift to function.

BATTERY

- 100%
- 50%
- **MUST BE CHARGED**

Charger, key for manual emergency lowering.

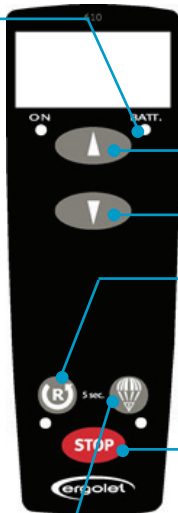
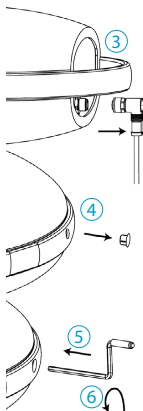

Lift up

Lift down

Reset

If the RESET button flashes: Press RESET down for 5 seconds, and the lift works again.

Emergency stop

EMERGENCY LOWERING

- 1 Activate the powered emergency lowering on the hand control

If the electrical powered emergency lowering is not working, use the manual emergency lowering:

- 2 Take the key from the top of the charger.
- 3 Remove the hand control.
- 4 Remove the plug on the side of the Luna.
- 5 Put the key into the Luna.
- 6 Turn the key counter clockwise to lower the user.

CHARGING

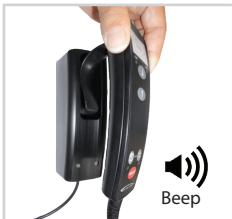

ALWAYS REMEMBER

To move the Luna to the charging station and place the hand control into the charger.



SLING

1) The sling strap is placed on the hook in its open position.

2) The sling strap is pulled downwards so that the hook closes.

3) To release the strap after lifting, simply pull upwards to open the hook.

