



UNIVERSITY OF LATVIA

Erasmus code	LV RIGA01
PIC	999871830
Address	Raina Blvd. 19, Riga, LV-1586, Latvia
Website	https://www.lu.lv/en/
Rector	Professor Indrikis MUIZNIEKS

INTERNATIONAL RELATIONS

Address	Raina Blvd. 19, Riga, LV-1586, Latvia
Website	https://www.lu.lv/en/admission/for-international-students/exchange/contacts/
Erasmus Institutional Coordinator	Ms. Sintija MACULEVICA
Phone	+371 6703 3968
E-mail	ad@lu.lv
Head of Mobility Division	Ms. Beate RAMINA – LO BELLO
Phone	+371 6703 4713
E-mail	beate.ramina@lu.lv
Contact person for outgoing students	Ms. Alise BULIGINA
Phone	+371 6703 4706
E-mail	alise.buligina@lu.lv
Contact person for incoming students	Ms. Aleksandra KJAKSTE
Phone	+371 6703 4712
E-mail	marta.vilkausa@lu.lv
Contact person for incoming students (from non EU countries)	Ms. Aleksandra KJAKSTE
Phone	+371 6703 4712
E-mail	aleksandra.kjakste@lu.lv
Contact person for IIA Erasmus+ agreements with Programme Countries	Ms. Aleksandra KJAKSTE
Phone	+371 6703 4712
E-mail	alise.buligina@lu.lv
Contact person for IIA Erasmus+ agreements with Partner Countries	Ms. Aleksandra KJAKSTE
Phone	+371 6703 4712
E-mail	aleksandra.kjakste@lu.lv



INFORMATION FOR INTERNATIONAL STUDENTS	
Academic calendar 2023/2024	
Autumn semester	
<i>registration week</i>	28.08.2023 - 03.09.2023
<i>studies</i>	04.09.2023 - 23.12.2023
<i>Christmas and New Year holidays</i>	24.12.2023 - 01.01.2024
<i>individual studies and exams</i>	02.01.2024 - 26.01.2024
Spring semester	
<i>registration week</i>	30.01.2024 - 04.02.2024
<i>studies</i>	05.02.2024 - 01.04.2024
<i>Easter holidays</i>	02.04.2024 - 07.04.2024
<i>studies</i>	08.04.2024 - 02.06.2024
<i>individual studies and exams</i>	03.06.2024 - 30.06.2024
Website	https://www.lu.lv/en/studies/study-process/academic-calendar/
Application deadlines	Autumn Spring May 15 th November 15 th
Nomination deadlines (by e-mail exchange@lu.lv)	Autumn Spring April 15 th October 15 th
Language of instructions	The official language of instruction is Latvian. Courses for international students are offered in English.
Language requirements	English B1 Students applying for the following faculties have additional language requirements: Faculty of Humanities <i>Bachelor level programmes:</i> English philology (English B2) Modern Languages and Business Studies (English B2) French philology (French, Italian or Spanish B1) German philology (German B1) Russian philology (Russian B2) <i>Master level programmes:</i> English philology (English B2) Romance studies (French, Italian or Spanish B2) German philology (German B2) Russian philology (Russian B2) Translation "Latvian-English-Russian" studies - English B2 and Russian B2



	Faculty of Education, Psychology and Art Psychology (English B2) Faculty of Medicine Medicine and Dentistry programmes: English B2
Application information for incoming students	https://www.lu.lv/en/admissions/exchange-studies/
Accommodation information	https://www.lu.lv/en/studies/student-life/accommodation/
Courses for incoming students	https://www.lu.lv/en/gribustudet/arzemju-studentiem-eng/exchange/courses/
Immigration information	https://www.lu.lv/en/gribustudet/arzemju-studentiem-eng/exchange/visas/
General and Practical information for incoming students	https://www.lu.lv/en/admission/for-international-students/degree/advice/
Credit points	1 Latvian credit point = 1.5 ECTS
Approx. expenses per month	
Accommodation	116 – 300 EUR
Food & drinks	300 EUR
Books	20 EUR
Local Transportation	15 EUR
<i>Total</i>	<i>450 – 650 EUR</i>

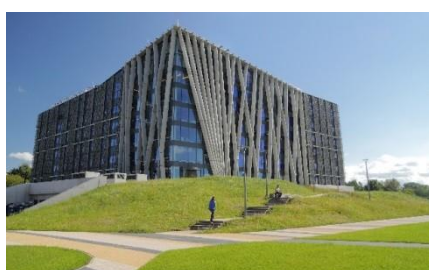



INTERNATIONAL COORDINATORS AT FACULTIES

FACULTY OF BIOLOGY	
Departmental Coordinator	Assoc. prof. Liga OZOLINA-MOLLA
E-mail	liga.ozolina-molla@lu.lv
FACULTY OF CHEMISTRY	
Departmental Coordinator	Doc. Agnese ARAJA
E-mail	agnese.araja@lu.lv
FACULTY OF COMPUTING	
Departmental Coordinator	Prof. Zane BICEVSKA
E-mail	zane.bicevska@lu.lv
FACULTY OF BUSINESS, MANAGEMENT AND ECONOMICS	
Departmental Coordinator	Ms. Nora Batraga
E-mail	Nora.batraga@lu.lv
FACULTY OF EDUCATION, PSYCHOLOGY AND ART	
Departmental Coordinator	Ms. Alise Olesika
E-mail	alise.olesika@lu.lv
FACULTY OF GEOGRAPHY AND EARTH SCIENCES	
Departmental Coordinator	Prof. Zaiga KRISJANE
E-mail	zaiga.krisjane@lu.lv
FACULTY OF HISTORY AND PHILOSOPHY	
Departmental Coordinator	Ginta Ieva Bikše
E-mail	ginta_ieva.bikse@lu.lv



INTERNATIONAL COORDINATORS AT FACULTIES

FACULTY OF HUMANITIES	
Departmental Coordinator	Ms. Margarita SPIRIDA
E-mail	margarita.spirida@lu.lv
FACULTY OF LAW	
Departmental Coordinator	Ms. Viktorija Gilberte
E-mail	viktorija.gilberte@lu.lv
FACULTY OF MEDICINE	
Departmental Coordinator	Mr. Ivars PEKAINIS
E-mail	ivars.pekainis@lu.lv
FACULTY OF PHYSICS, MATHEMATICS AND OPHTHOMETRY	
Departmental Coordinator, Coordinator for Department of Physics	Doc. Imants Kaldre
E-mail	imants.kaldre@lu.lv
Coordinator for Department of Mathematics	Doc. Olga Grigorenko
E-mail	olga.grigorenko@lu.lv
Coordinator for Department of Optometry	Dace Rutkovska
E-mail	dace.ruktovska@lu.lv
FACULTY OF SOCIAL SCIENCES	
Departmental Coordinator:	Ms. Aleksandra KJAKSTE
E-mail	aleksandra.kjakste@lu.lv
FACULTY OF THEOLOGY	
Departmental Coordinator	Doc. Janis RUDZITIS-NEIMANIS
E-mail	janis.rudzitis@lu.lv